

Record 20.00
Ex. Fee
Date 4-10-12
9012

FILE FOR RECORD
2012 APR 13 AM 9:45

LARRY R. CARROLL
EDMONSON COUNTY CLERK
BY: [Signature] D.C.
STATE OF KENTUCKY
EDMONSON COUNTY
SCT. AMOUNT PAID: 00.00
I, [Signature], County Clerk of Edmonson County, Kentucky, do hereby certify that the foregoing instrument was filed in my office on the 9th day of April, 2012, at [Location], Kentucky, and that the same is a true and correct copy of the original as the same appears in my office.
BY: [Signature] BUTCH CARROLL, CLERK
EDMONSON COUNTY, KENTUCKY
OFFICE: [Address]

ACCESS RESTRICTION NOTE
RED ROCK OF NOLIN LAKE LOTS WILL HAVE TO DIRECT ACCESS AN EXISTING LAKEHOUSE DRIVE OR FROM DIPLOMAT SHORES. ALL RED ROCK OF NOLIN LAKE LOT ENTRANCES SHALL BE CONSTRUCTED OFF OF THE NEW SUBDIVISION ROADS, RED ROCK DRIVE AND RED ROCK COURT.

ACCESS RESTRICTION NOTE
RED ROCK OF NOLIN LAKE LOTS WILL HAVE TO DIRECT ACCESS AN EXISTING LAKEHOUSE DRIVE OR FROM DIPLOMAT SHORES. ALL RED ROCK OF NOLIN LAKE LOT ENTRANCES SHALL BE CONSTRUCTED OFF OF THE NEW SUBDIVISION ROADS, RED ROCK DRIVE AND RED ROCK COURT.

ACCESS RESTRICTION NOTE
RED ROCK OF NOLIN LAKE LOTS WILL HAVE TO DIRECT ACCESS AN EXISTING LAKEHOUSE DRIVE OR FROM DIPLOMAT SHORES. ALL RED ROCK OF NOLIN LAKE LOT ENTRANCES SHALL BE CONSTRUCTED OFF OF THE NEW SUBDIVISION ROADS, RED ROCK DRIVE AND RED ROCK COURT.

ACCESS RESTRICTION NOTE
RED ROCK OF NOLIN LAKE LOTS WILL HAVE TO DIRECT ACCESS AN EXISTING LAKEHOUSE DRIVE OR FROM DIPLOMAT SHORES. ALL RED ROCK OF NOLIN LAKE LOT ENTRANCES SHALL BE CONSTRUCTED OFF OF THE NEW SUBDIVISION ROADS, RED ROCK DRIVE AND RED ROCK COURT.

ACCESS RESTRICTION NOTE
RED ROCK OF NOLIN LAKE LOTS WILL HAVE TO DIRECT ACCESS AN EXISTING LAKEHOUSE DRIVE OR FROM DIPLOMAT SHORES. ALL RED ROCK OF NOLIN LAKE LOT ENTRANCES SHALL BE CONSTRUCTED OFF OF THE NEW SUBDIVISION ROADS, RED ROCK DRIVE AND RED ROCK COURT.

ACCESS RESTRICTION NOTE
RED ROCK OF NOLIN LAKE LOTS WILL HAVE TO DIRECT ACCESS AN EXISTING LAKEHOUSE DRIVE OR FROM DIPLOMAT SHORES. ALL RED ROCK OF NOLIN LAKE LOT ENTRANCES SHALL BE CONSTRUCTED OFF OF THE NEW SUBDIVISION ROADS, RED ROCK DRIVE AND RED ROCK COURT.

ACCESS RESTRICTION NOTE
RED ROCK OF NOLIN LAKE LOTS WILL HAVE TO DIRECT ACCESS AN EXISTING LAKEHOUSE DRIVE OR FROM DIPLOMAT SHORES. ALL RED ROCK OF NOLIN LAKE LOT ENTRANCES SHALL BE CONSTRUCTED OFF OF THE NEW SUBDIVISION ROADS, RED ROCK DRIVE AND RED ROCK COURT.

ACCESS RESTRICTION NOTE
RED ROCK OF NOLIN LAKE LOTS WILL HAVE TO DIRECT ACCESS AN EXISTING LAKEHOUSE DRIVE OR FROM DIPLOMAT SHORES. ALL RED ROCK OF NOLIN LAKE LOT ENTRANCES SHALL BE CONSTRUCTED OFF OF THE NEW SUBDIVISION ROADS, RED ROCK DRIVE AND RED ROCK COURT.

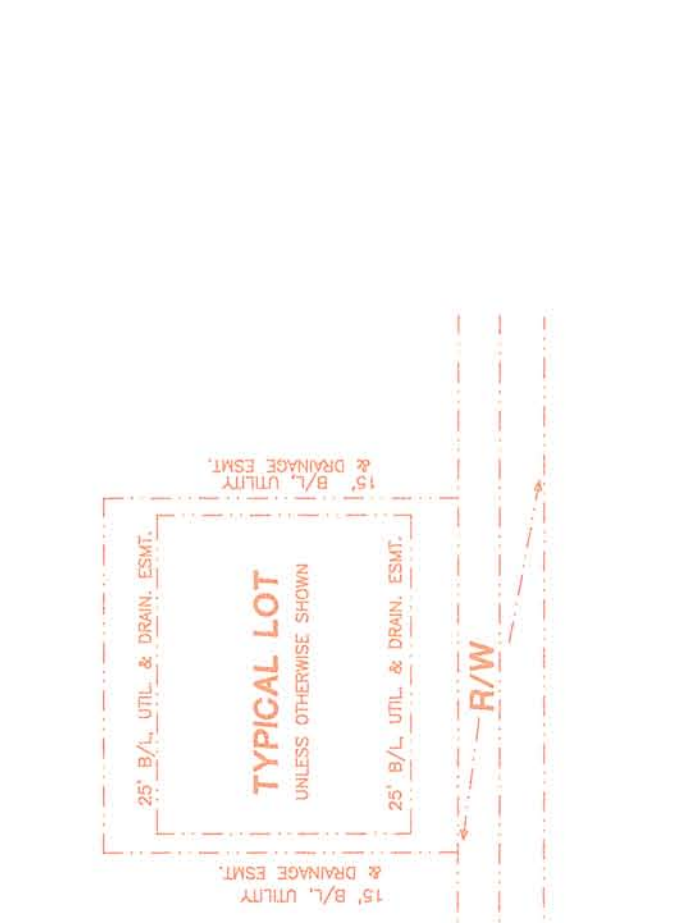
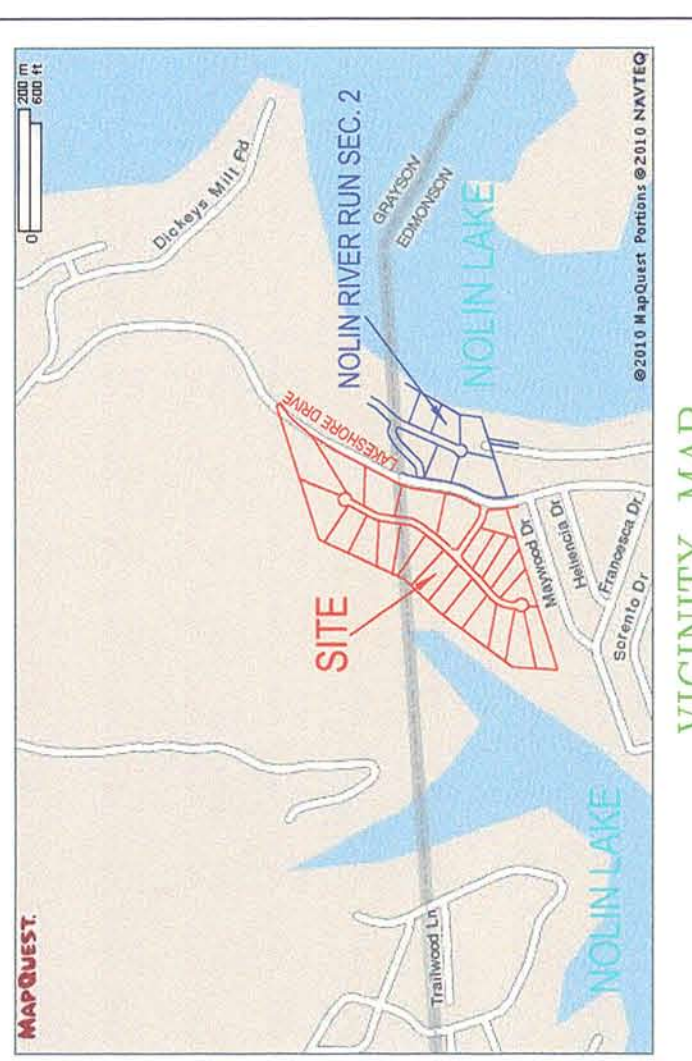

Table with 3 columns: LINE, BEARING, DISTANCE. Lists boundary measurements for various lots.

Table with 3 columns: CURVE, RADIUS, ARC LENGTH, CHORD BEARING. Lists curve data for the subdivision.



STATE OF KENTUCKY
COUNTY OF EDMONSON
The foregoing instrument was acknowledged before me on this 9 day of April, 2012, by Robert S. Martin, as President, and by Laura J. Martin, as Vice President, of Nooneyway LLC, a Kentucky corporation, on behalf of the corporation.
IN WITNESS WHEREOF, Nooneyway LLC, a Kentucky Corporation, has caused its name to be hereunto subscribed by its duly authorized partners this 9 day of April, 2012, at [Location], Kentucky.
NOONEYWAY LLC
BY: ROBERT S. MARTIN, PRESIDENT
BY: LAURA J. MARTIN, SECRETARY/TREASURER
NOTARY PUBLIC
My commission expires: [Date]
[Signature]

EASEMENT NOTE

THE 20' WALKWAY EASEMENTS SHOWN HEREON ALONG THE ENTIRE WESTERN BOUNDARY OF LOTS 7 THROUGH 19 AND ALONG THE DIVISION LINES BETWEEN LOTS 16 & 15; LOTS 12 & 11 AND LOTS 9 & 8 ARE FOR THE EXCLUSIVE USE OF RED ROCK OF NOLIN LAKE PROPERTY OWNERS.

- LEGEND
- 1/2" x 18" STEEL REBAR SET WITH ID CAP #3383
- 1/2" REBAR FOUND WITH ID CAP #2811
- 1/2" PIPE (FOUND)
- 1/2" REBAR FOUND WITH ID CAP #1701
- 1/2" REBAR FOUND WITH NO ID CAP
- CALCULATED MEANDER POINTS

CERTIFICATION OF APPROVAL FOR RECORDING
I HEREBY CERTIFY THAT THE SUBDIVISION PLAT SHOWN HEREON IS A TRUE AND CORRECT SURVEY IN ACCORDANCE WITH THE REGULATIONS OF THE DIVISION OF LAND SURVEYING OF THE COMMONWEALTH OF KENTUCKY. I HAVE REVIEWED THE PLAT AND THE MEASUREMENTS AND THE CALCULATIONS AND I HAVE FOUND THEM TO BE CORRECT AND ACCURATE. I HAVE ALSO REVIEWED THE MEASUREMENTS AND THE CALCULATIONS AND I HAVE FOUND THEM TO BE CORRECT AND ACCURATE. I HAVE ALSO REVIEWED THE MEASUREMENTS AND THE CALCULATIONS AND I HAVE FOUND THEM TO BE CORRECT AND ACCURATE.

CERTIFICATION OF OWNERSHIP AND DEDICATION
I (WE) HEREBY CERTIFY THAT I AM (WE) ARE THE OWNER(S) OF THE PROPERTY SHOWN AND DESCRIBED HEREON AND RECORDED IN DEED BOOK 207 PAGE 39 AND THAT I (WE) HEREBY ADOPT THIS PLAN OF SUBDIVISION WITH MY(OUR) FREE CONSENT, ESTABLISH THE MINIMUM BUILDING RESTRICTION LINES, AND DEDICATE ALL STREETS, ALLEYS, WALKS PARKS AND OTHER OPEN SPACES TO PUBLIC OR PRIVATE USE AS SHOWN IN ACCORDANCE WITH THE SUBDIVISION REGULATIONS OF EDMONSON COUNTY, KENTUCKY, UNLESS OTHERWISE NOTED.

SURVEYOR'S CERTIFICATION
I HEREBY CERTIFY THAT THIS PLAT DEPICTS A SURVEY MADE BY ME OR UNDER MY DIRECT SUPERVISION BY THE METHOD OF GPS - DIRECT MEASUREMENT OR RANDOM TRAVERSE, AND MEETS ALL OF THE REQUIREMENTS AND PRECISION SPECIFICATIONS OF THIS CLASS. THE ADJUSTED PRECISION RATIO OF CLOSURE IS 1:10,000 OR GREATER. THE ANGULAR AND LINEAR MEASUREMENTS HAVE NOT BEEN ADJUSTED FOR CLOSURE AND ARE CORRECT TO THE BEST OF MY KNOWLEDGE AND BELIEF.

CLEMONS & ASSOCIATES
LAND SURVEYING
103 SOUTH CLINTON STREET
LEITCHFIELD, KY 42754
PHONE: (270) 259-5698 OR 259-6674
ELIZABETHTOWN, KY, 42701
PHONE: (270) 766-1112

AMMENDED PLAT
RED ROCK OF NOLIN LAKE
OWNERS: NOONEYWAY, LLC
SURVEYED BY: CLEMONS AND ASSOCIATES LAND SURVEYING - DARREN CLEMONS
103 SOUTH CLINTON STREET, ELIZABETHTOWN, KY 42701
DATE: 04/03/2012
SOURCE OF TITLE: DB 207, PG. 39 SUBDIVIDED APRIL 21, 2010; PG. 3, SLIDE 537
DISTANCES: EDMOPRS
DRAWN BY: DLCCGB
APPROVED BY: DLIC
PROJECT: RECORDED ROCKING